



# **REMOTE CONTROLLER** **OWNER'S MANUAL**



16117000001555  
CA05R-RG67N(A)  
2018.01.04

# CONTENT

1. QUICK START	2
2. DISPLAY AND BUTTONS	3
2.1 Display	3
2.2 Buttons	4
3. HOW TO USE BASIC FUNCTIONS	5
3.1 Basic Operations	5
3.2 Timer Function	6
4. HOW TO USE ADVANCED FUNCTIONS	7

## CAUTION

### INSTRUCTIONS OF USING WIRELESS REMOTE CONTROL

- The remote control uses two alkaline batteries (1.5 Volts).
- Do not use old batteries or batteries of different types, as this may cause the controller malfunction.
- If you do not use the remote control for more than two months, please remove the batteries. Otherwise battery leakage may damage the remote control.
- The average battery life during normal use is approximately half a year. Replace the batteries when there is no receiving beep coming from the indoor unit or transmission indicator  on the remote control fails to light.
- The maximum operating distance for the remote control is approximately 8 meters.
- The transmitter of remote control must be directed toward the receiver of indoor unit when pressing the buttons of the desired functions. An acoustical acknowledgement sound (beep) will indicate that signal has been received.
- Avoid obstacles obstructions such as curtains, doors or other materials between the remote control and the receiver of indoor unit to avoid blocking the signals from the remote control to the indoor unit.
- Avoid direct sunlight on the receiver of indoor unit, which may interfere with good signal reception and the air conditioner may not work properly. Draw the curtains to avoid direct sunlight.
- Keep the remote control away from water. Do not let the remote control fall down.
- Never use objects with sharp point to press the button on the remote control.
- Prevent any liquid from falling into the remote control.
- If other electric applications react to the remote control, move these applications.
- Do not dispose of batteries as unsorted municipal waste. Refer to local laws for proper disposal of batteries.

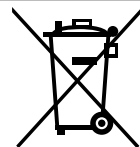

### Correct Disposal of Battery

- This marking printed in the batteries attached to your Air Conditioning product is information for end-users.
- Batteries, at their end-of-life, should be disposed of separately from general household waste. Please, dispose of batteries correctly at your local community waste collection or the recycling center.

## 1. QUICK START

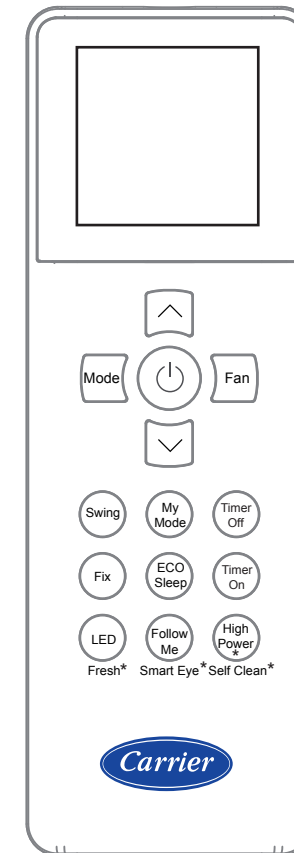

RG67N/BGEF, RG67N/BGCEF (17°C-30°C)  
RG67N10/BGEF (20°C-28°C)

\* Optional Functions:  
The function may be not available on the actual remote controller or not workable for the air conditioner.

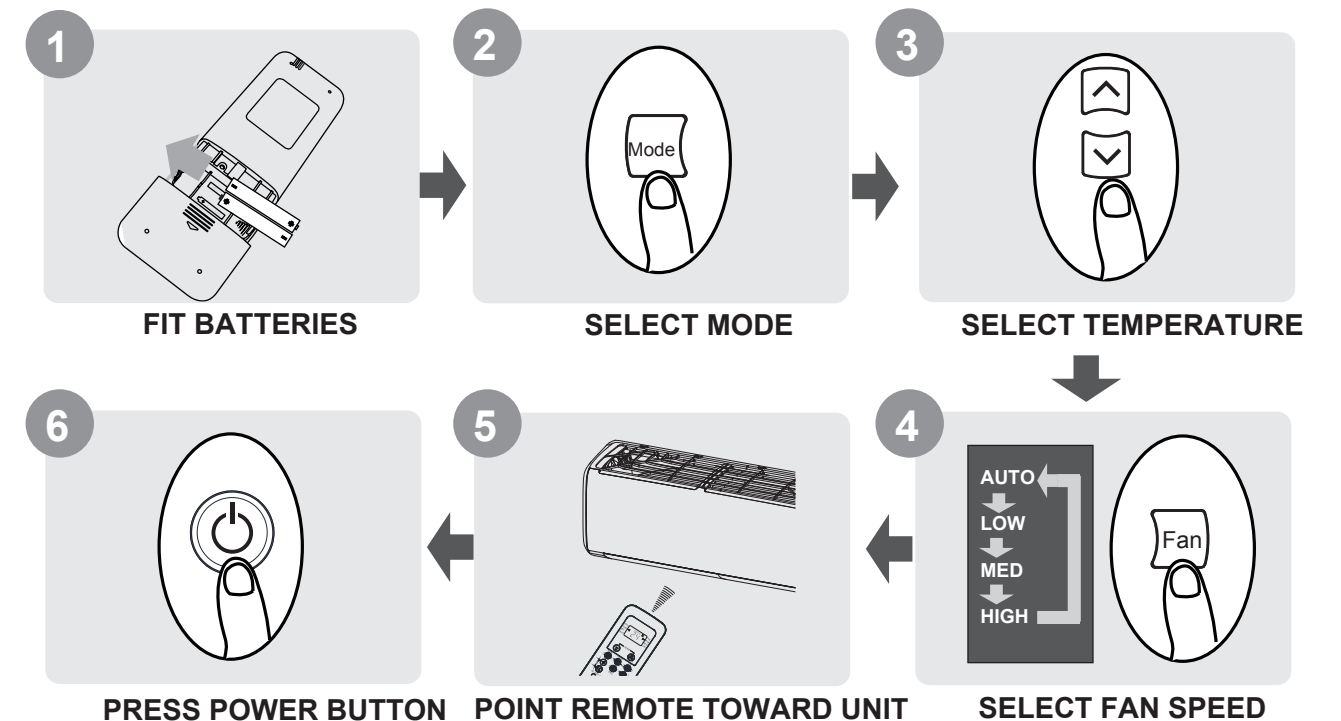

## 2. DISPLAY AND BUTTONS

### 2.1 DISPLAY

Information are displayed when the remote controller is powered up.

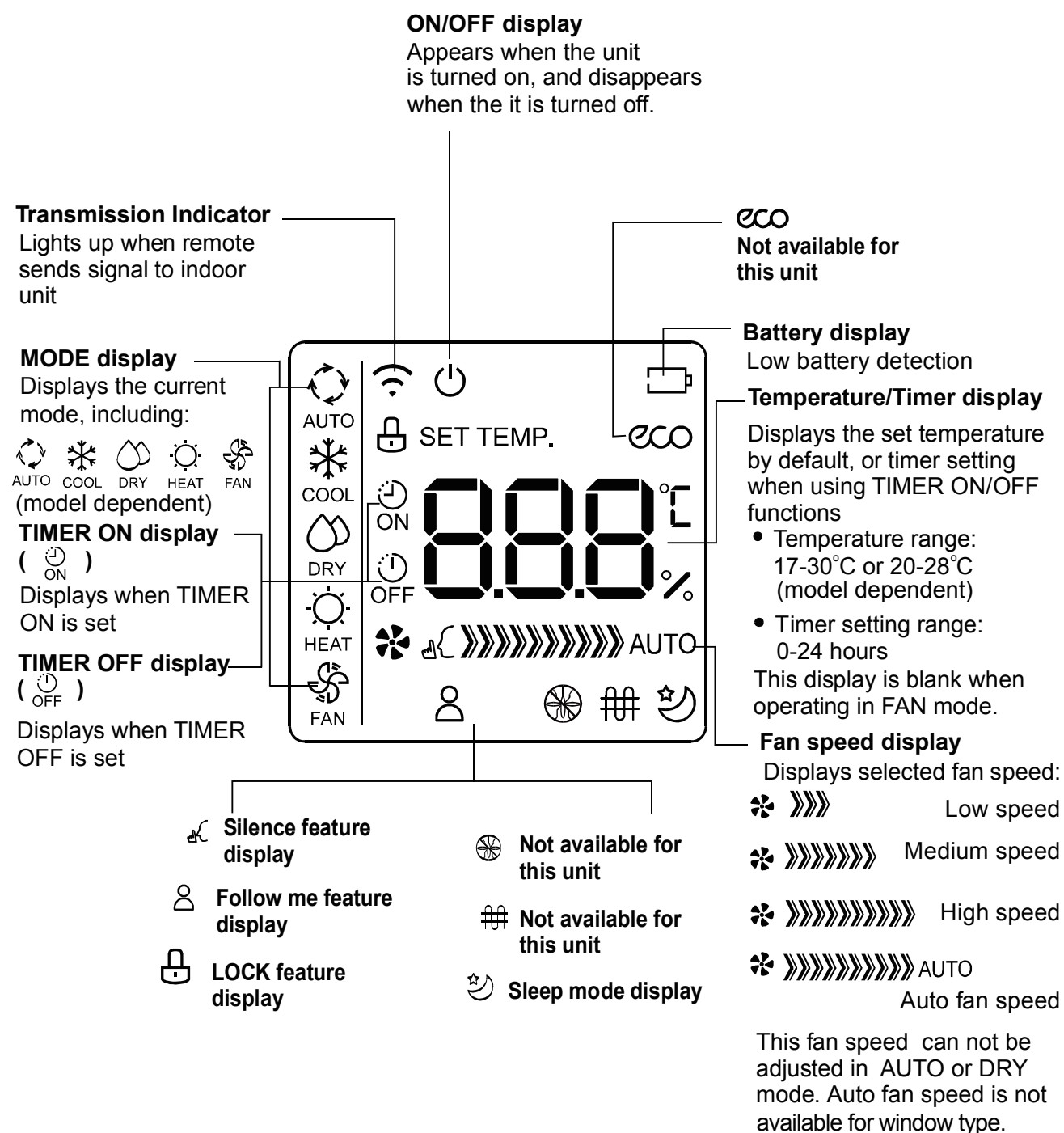

#### Note:

All indicators shown in the figure are for the purpose of clear presentation. But during the actual operation only the relative functional signs are shown on the display window.

### 2.2 BUTTONS

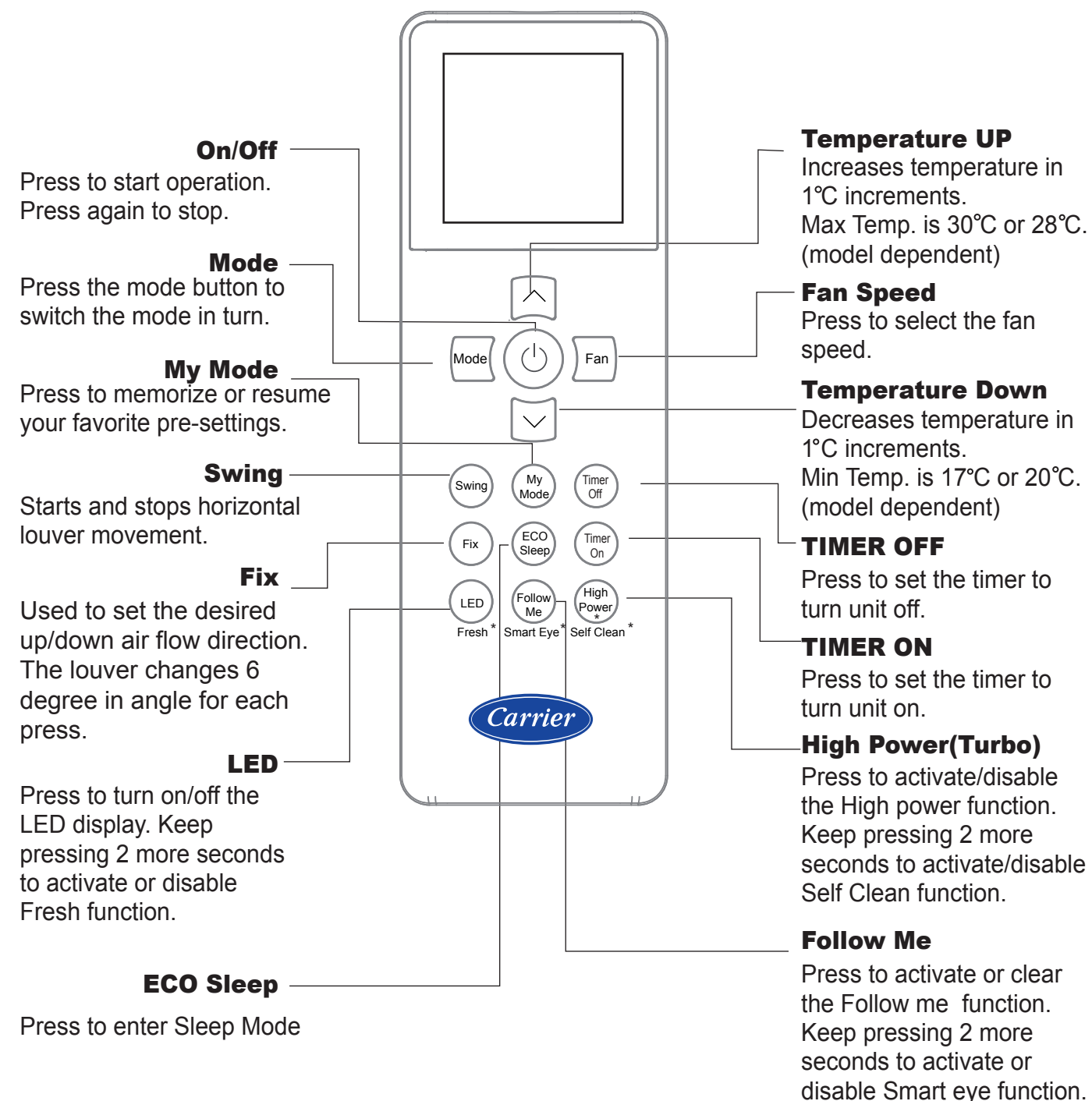

#### NOTE:

1. Above illustration shows all the features. For actual model, only the relevant parts are shown.
2. Buttons design might be slightly different from the actual one.

# 3. HOW TO USE BASIC FUNCTIONS

## 3.1 BASIC OPERATIONS

**! ATTENTION** Before operation, please ensure the unit is plugged in and power is available.

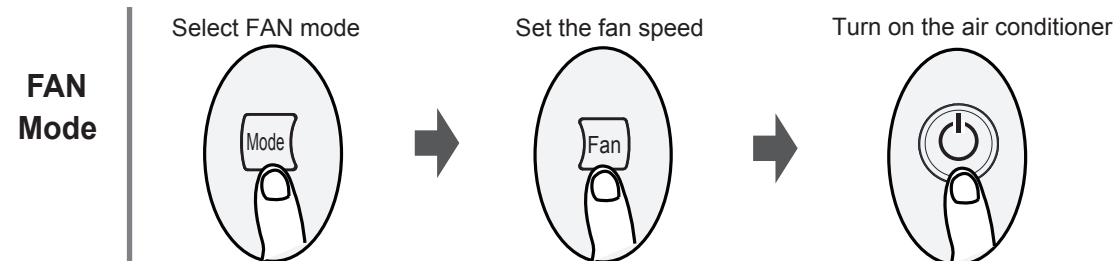
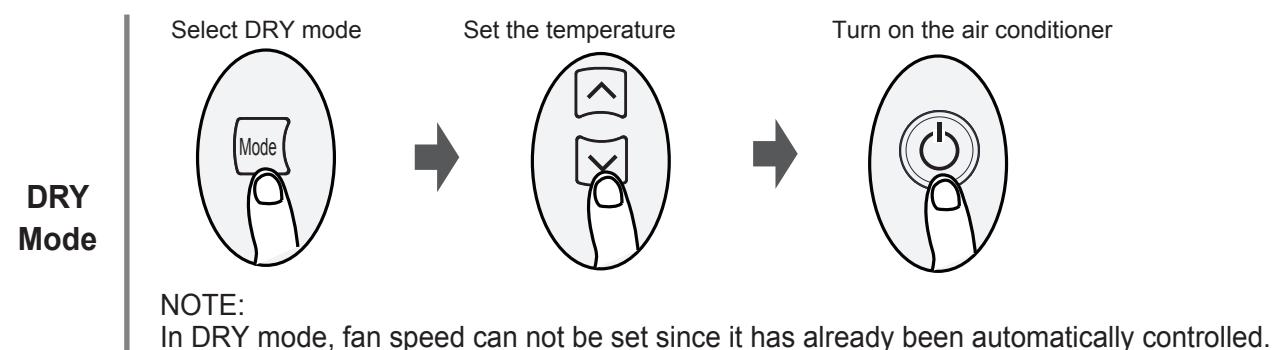
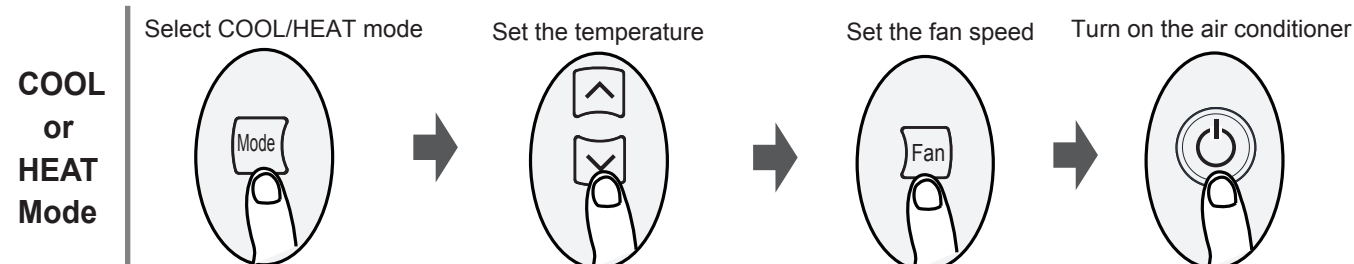
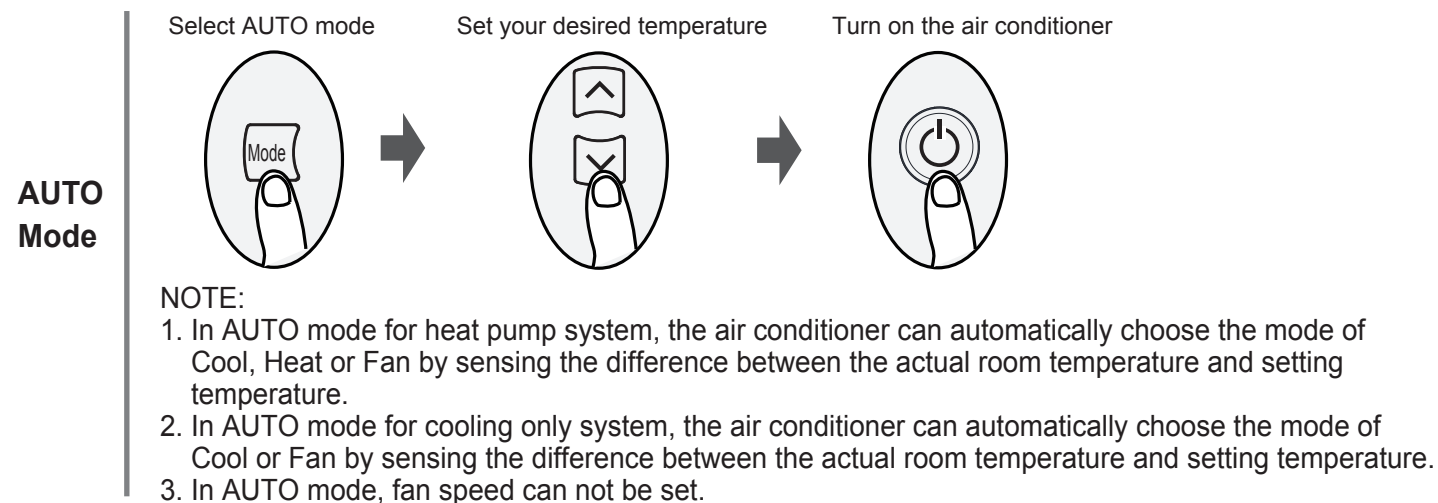

**NOTE:** AUTO mode and HEAT mode are not available for model of RG67N/BGCEF.

## 3.2 TIMER FUNCTION

**TIMER ON/OFF - Set the amount of time after which the unit will automatically turn on/off.**

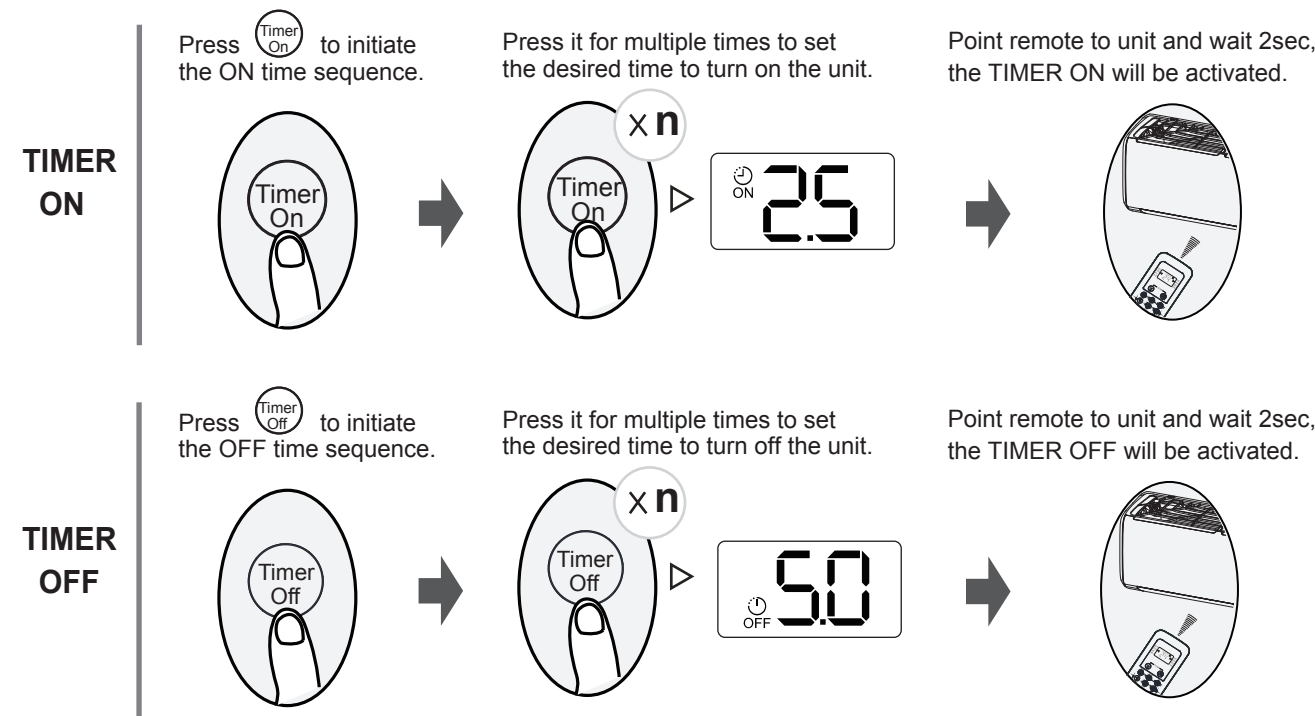

NOTE:

1. When setting the TIMER ON or TIMER OFF, the time will increase by 30 minutes increments with each press, up to 10 hours. After 10 hours and up to 24, it will increase in 1 hour increments. (For example, press 5 times to get 2.5h, and press 21 times to get 11h.) The timer will revert to 0.0 after 24.
2. Cancel either function by setting its timer to 0.0h.

**Setting TIMER ON & OFF (example).**

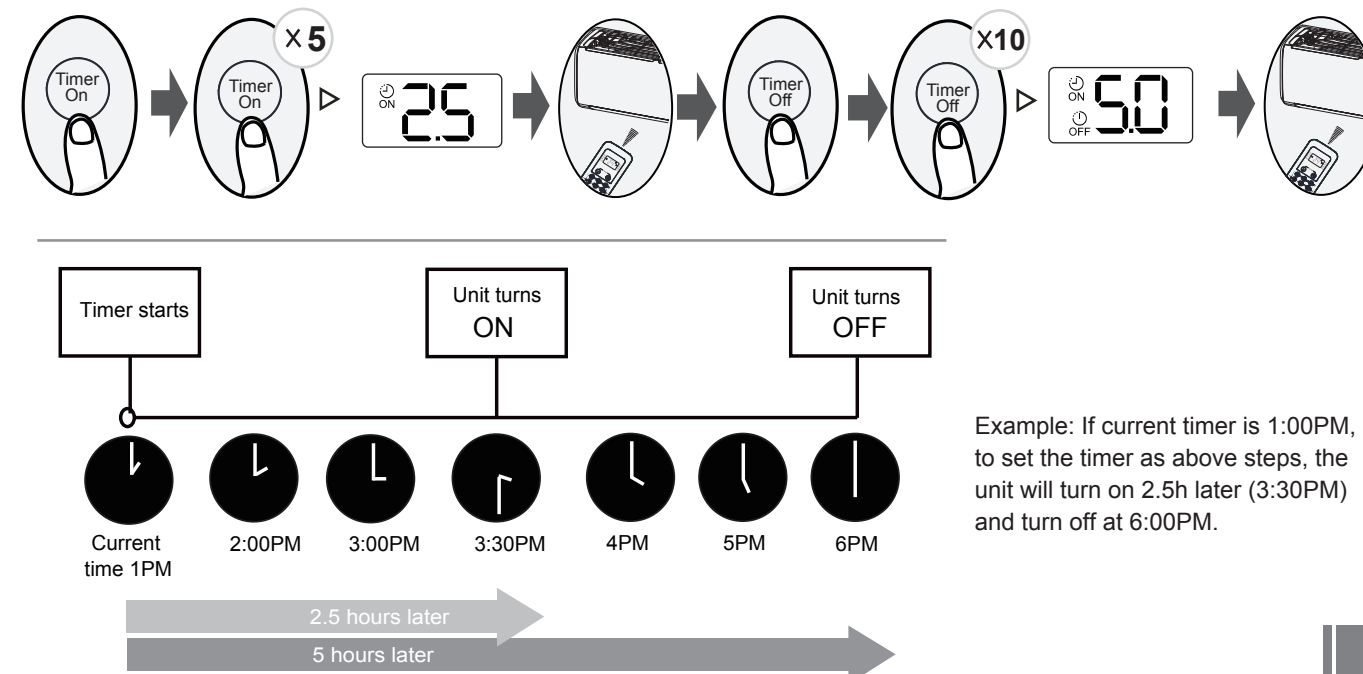

## 4. HOW TO USE ADVANCED FUNCTIONS

### Swing

Press Swing button

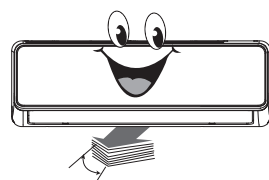
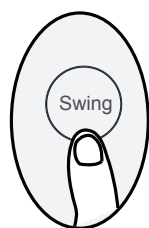

The horizontal louver will swing up and down automatically. For window type, the vertical louver will swing automatically. For floor standing type with manual horizontal louver, the vertical louver will swing automatically.

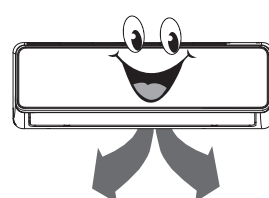
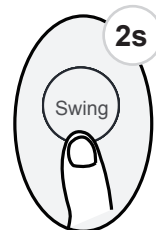

Keep pressing this button more than 2 seconds, the vertical louver swing function is activated or inactivated. (Model dependent)

### Follow Me or Smart eye

Press this button under COOL or HEAT operating Mode

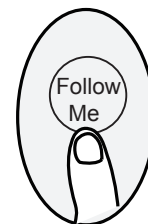

The controller will display the actual temp. at its location and send this signal to indoor unit every 3 minutes

Press this button to activate Follow me. This function can adjust room temperature base on the controller's sensor and make you comfort.

Note: Please put the controller in the location where can ensure the indoor unit can receive the signal.

Press this button more than 2 seconds

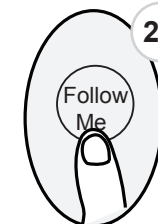

The smart eye feature is energized.

Keep pressing this button more than 2 seconds, the smart eye function is activated and will detect the people activities in the room. (Model dependent)

### Fix

Press Fix button

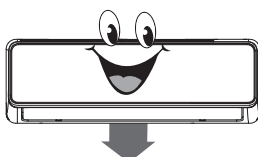
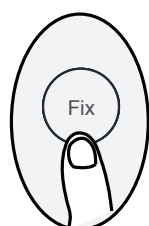

The horizontal louver will move an angle of 6 degree for each press. Press the button until the louver reach your prefer location. For window type, the vertical louver will swing automatically. For floor standing type with manual horizontal louver, the vertical louver will swing automatically.

### LED or Fresh

Press LED button

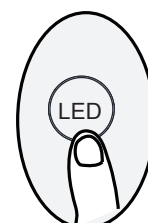

Press this button to turn on and turn off the display on the indoor unit.

Press this button more than 2 seconds

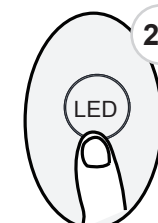

The ionizer or Plasma dust collector (model dependent) is energized.

Keep pressing this button more than 2 seconds, the fresh function is activated and will help to remove pollen and impurities from the air. (Model dependent)

### ECO Sleep

Press ECO Sleep button under AUTO/Cool/Heat mode



The set temp. will increase (cooling) or decrease (heating) by 1°C per hour for the first 2hs. Please refer to the OWNER'S MANUAL for more details.

This Sleep operation saves energy and improves night time comfort by synchronising with the body's metabolism. The sleep function is not available in FAN or DRY mode.

### High Power (Turbo) or Self Clean

Press this button

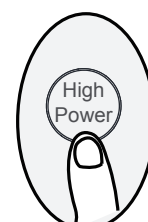

The unit will operate at the biggest capacity output to reach the setting Temp. quickly.

Press this button to activate High Power(Turbo) feature. It enables the unit to reach the set temperature in the shortest time. Press it again to disable it.(Model dependent)

Press this button under COOL or DRY Mode more than 2 seconds

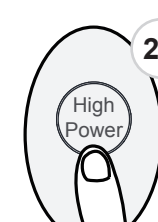

The unit will enter low fan mode to dry up the coil. The cleaning cycle takes 15~30 mins, after which the unit will turn off automatically.

Keep pressing this button more than 2 seconds, the unit will clean itself to avoid bacteria grow around heat exchanger.(Model dependent)

### My Mode

Press this button more than 2 seconds

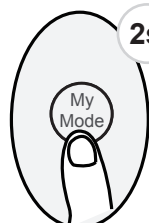

The unit will memorize the current setting mode, Temp., fan).

Press this button

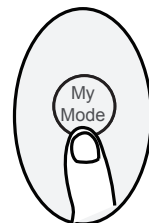

The unit will restore to the setting you made last time.

My Mode function enable you to memorize or restore your favorite settings (mode, temperature and fan speed). The default memorized setting is AUTO mode, 26°C and AUTO fan.  
NOTE: For model of RG67N/BGCEF, The default memorized setting is COOL mode, 26°C and AUTO fan.



## 4. HOW TO USE ADVANCED FUNCTIONS

### F.P.

Press this button 2 times during one second under HEAT Mode and setting temperature of 17°C(for model of RG67N/BG(C)EF) or 20°C(for model of RG67N10/BGEF).

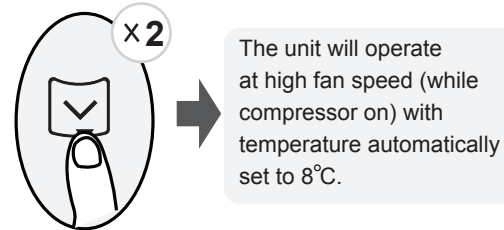

Note: This function is for heat pump air conditioner only. And it is not available for model of RG67N/BGCEF.  
Press this button 2 times under HEAT Mode and setting temperature of 17°C or 20°C to activate the freeze protection function. It will help to keep the room above 0°C (freezing point) in severe cold winter.  
Press On/Off, Sleep, Mode, Fan and Temp. button while operating will cancel this function.

### Lock Mode 1

Press together button and button at the same time more than 2 seconds to activate Lock Mode 1 function.

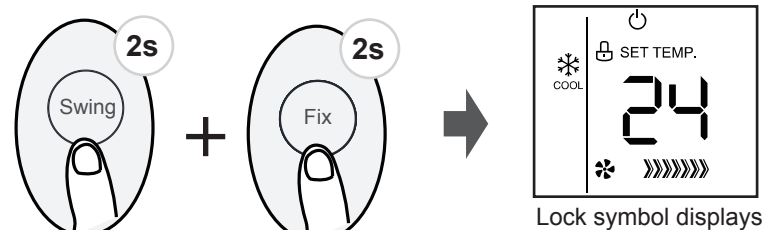

Enter lock mode 1 by pressing and button at the same time more than 2 seconds. At lock mode 1, all buttons will not response except press these two buttons again to disable locking.

### Lock Mode 2

Press together TIMER ON button and TIMER OFF button at the same time more than 2 seconds to activate lock mode 2 function.

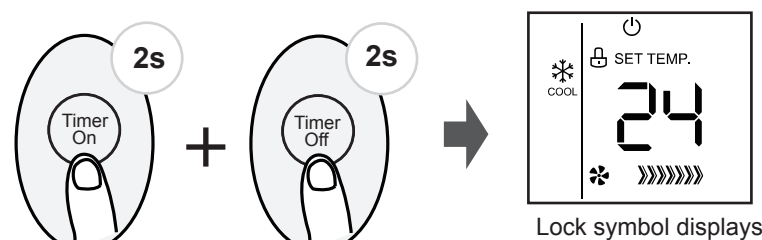

Enter lock mode 2 by pressing TIMER ON and TIMER OFF button at the same time more than 2 seconds. At lock mode 2, all buttons will not response except press ON/OFF, TEMP UP and DOWN buttons or press these two buttons again to disable locking.

### Silence

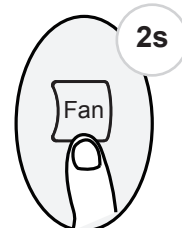

Due to low frequency operation of compressor, it may result in insufficient cooling and heating capacity.  
Press ON/OFF, Mode, Sleep button, turn on F.P. or Self clean function while operating will cancel silence function. (Model dependent)